

**SLIM SLIDES - MANUAL VERSION**

**ROTOLIN**  
*everything under control...*

# • SLIM-SLIDES - MANUAL VERSION •

## INTRODUCTION

Quick trouble free compact emergency slide valve for the isolation and flow control of free flowing powders, granules and dust.

Ideal for various types of gravity feed applications e.g. silos, hoppers, screw conveyors etc., where easy access or infrequent use lends itself to manual operations.

## WHY SLIM SLIDE

Meeting the needs of an Emergency Slide Valve.

## IMPORTANT FEATURES

- Compact Design
- No Lodgement Points
- Minimum Dust Escapement
- Precision Machined
- Stainless Steel Slide Plate
- Aluminium Body
- Nylon Support Studs
- Stainless Steel Slide Plate
- Dust Seals
- Round and Square Inlets

## SLIM SLIDE

The Slim Slide by careful design has a build up facility and by adding further components it can easily be converted from the manual version to:

- Single Pneumatic Operation
- Screw Type
- Motorized

That is Slim Slide, a cost effective valve for trouble free operation.

Manufactured on CNC machines ensuring:

- Quick Deliveries
- Interchangeability
- Accurate Components
- Cost Effectiveness
- Quality Control



Slim-Slide  
Manual Circular Inlet

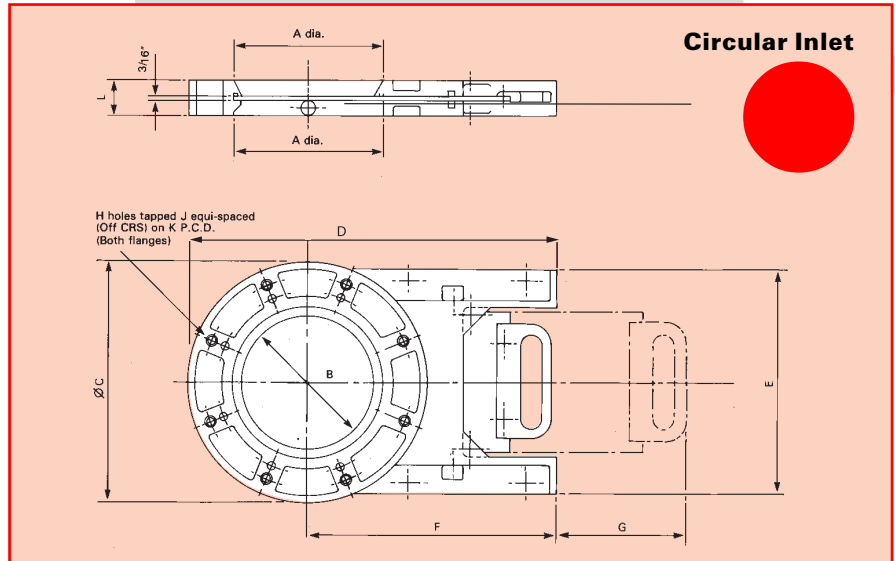

	A	B	C	D	E	F	G	H	J	K	L	M	
VALVE SIZE	350	350	325	533	725	458	458	350	12	M20	445	50	22.5
	300	300	275	440	628	400	408	303	12	M20	395	50	22.5
	250	250	225	370	543	338	358	253	8	M16	320	50	22.5
	200	200	175	320	495	300	335	173	8	M16	280	50	22.5
	150	150	125	285	400	250	258	153	8	M16	241	50	22.5
	125	125	100	240	353	215	233	127	8	M16	200	50	22.5

Dimensions in millimetres unless stated

Dimensions subject to change without notice

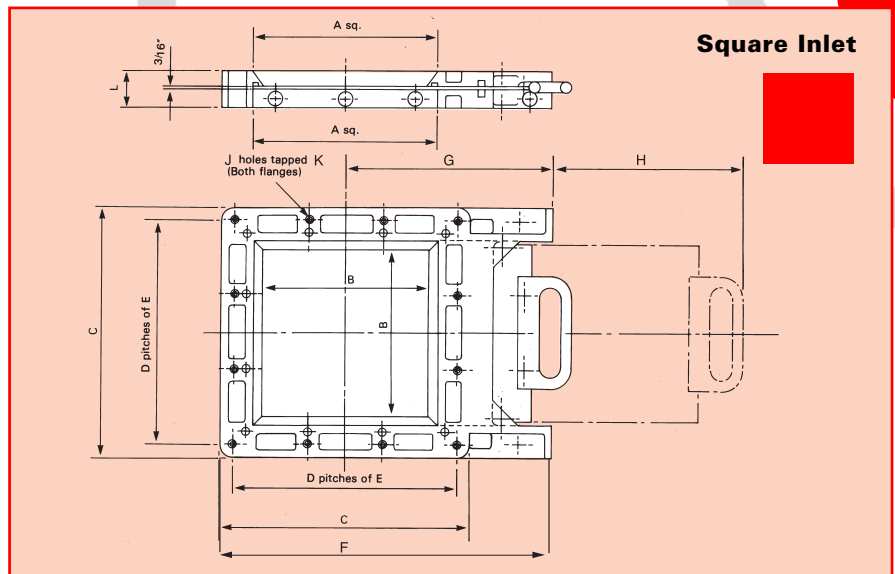

	A	B	C	D	E	F	G	H	J	K	L	M	
VALVE SIZE	350	350	325	458	3	140	568	339	353	12	M12	50	22.5
	300	300	275	400	3	119	510	310	305	12	M10	50	22.5
	250	250	225	338	3	101.5	448	279	255	12	M12	50	22.5
	200	200	175	300	3	90	450	300	175	12	M10	50	22.5
	150	150	125	250	3	70	360	235	175	12	M10	50	22.5

Dimensions in millimetres unless stated

Dimensions subject to change without notice